

RESIDENTIAL BUILDING CODE
OF THE STATE OF NEW YORK
COMPLIANCE FORM

PROJECT LOCATION: 22 KNELL DRIVE
MASSAPEQUA PARK, NY

ZONING:
N.C.T.M.

BUILDING PLANNING

R301 LOCAL DESIGN CRITERIA
(TABLE R301.2(1) UNLESS OTHERWISE NOTED)

BUILDINGS AND STRUCTURES AND PARTS THEREOF, SHALL BE CONSTRUCTED TO SAFELY SUPPORT ALL LOADS, INCLUDING DEAD LOADS, LIVE LOADS, ROOF LOADS, FLOOR LOADS, SNOW LOADS, WIND LOADS, AND SEISMIC LOADS AS PRESCRIBED BY THIS CODE.

FLOOR LIVE LOAD (TABLE R301.4)	<u>40 @ 1st</u>
ROOF LIVE LOAD (TABLE R301.5)	<u>16</u> psf
ROOF SNOW LOAD	<u>.71 x 42 = 31</u> psf
BASIC WIND SPEED	<u>110</u> mph
WIND EXPOSURE CATAGORY (R301.2.1.4)	<u>B</u>
HIGH WIND (> 110 mph) DESIGN CRITERIA	<u>AF & PA 1995</u> <u>HIGH WIND EDITION</u>
SEISMIC DESIGN CATAGORY (SDC)	<u>C</u>
SDC C & D PROVISIONS (R301.2.2)	<u>N.A.</u>
WEATHERING AREA	<u>SEVERE</u>
FROST LINE DEPTH	<u>3 FEET</u>
TERMITE AREA	<u>MODERATE/HEAVY</u>
DECAY AREA	<u>SLIGHT/MODERATE</u>
WINTER DESIGN TEMPERATURE	<u>11° F</u>
ICE SHEILD UNDERLAYMENT	<u>REQUIRED</u>
FLOOD HAZARDS	<u>AS PER F.E.M.A.</u>

5/4" ROOF LATH

DBL JOIST TENSION CONNECTION

THROUGH BOLT

NOTE:

SEE 'VIXEN HILL' SHOP DRAWINGS FOR ASSEMBLY DETAILS

4 X 4 POST

STEEL CONNECT PLATE

THROUGH BOLT

2 X 3 SUB JOIST

2 X 6 DECKING

THROUGH BOLT

TE ANGLE

2 X 6 JOIST

1/2" ANCHOR BOLT

8" Ø CONC. PIER

SECTION

3
A-1

1" = 1'-0"

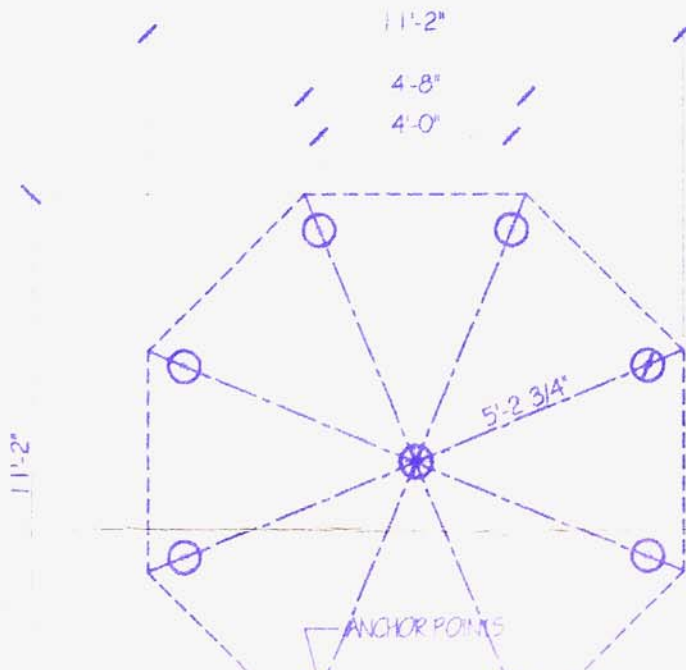

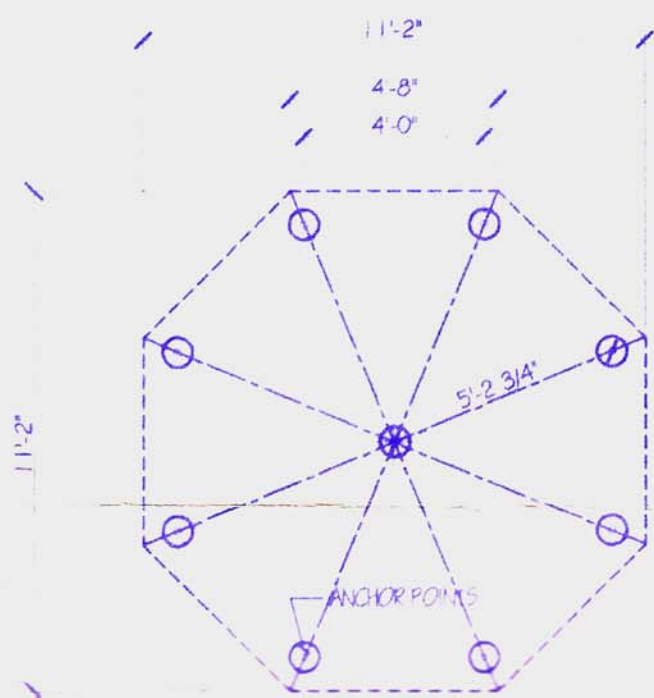
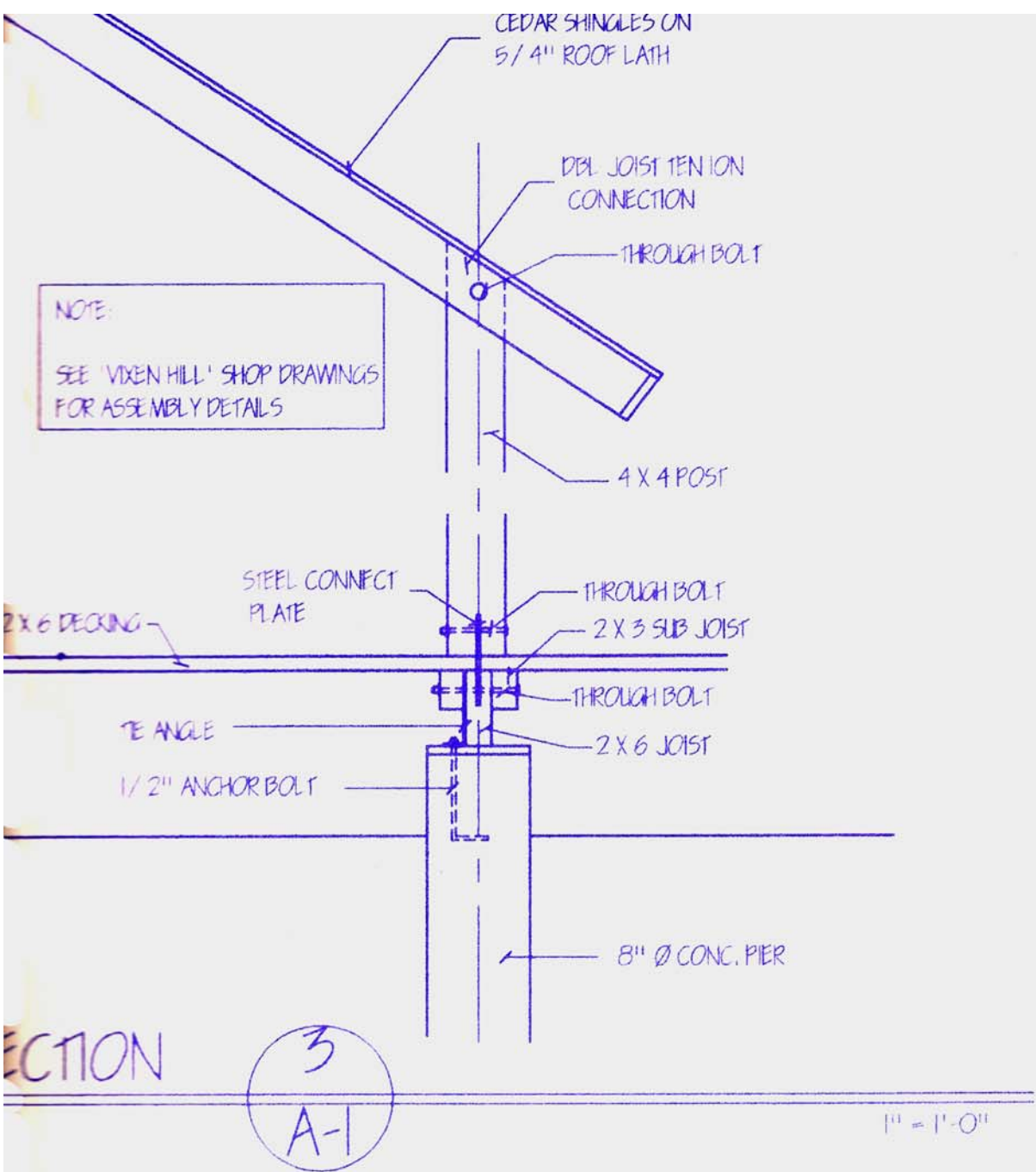

GAZEBO FOUNDATION PLAN

1/4" = 1'-0"

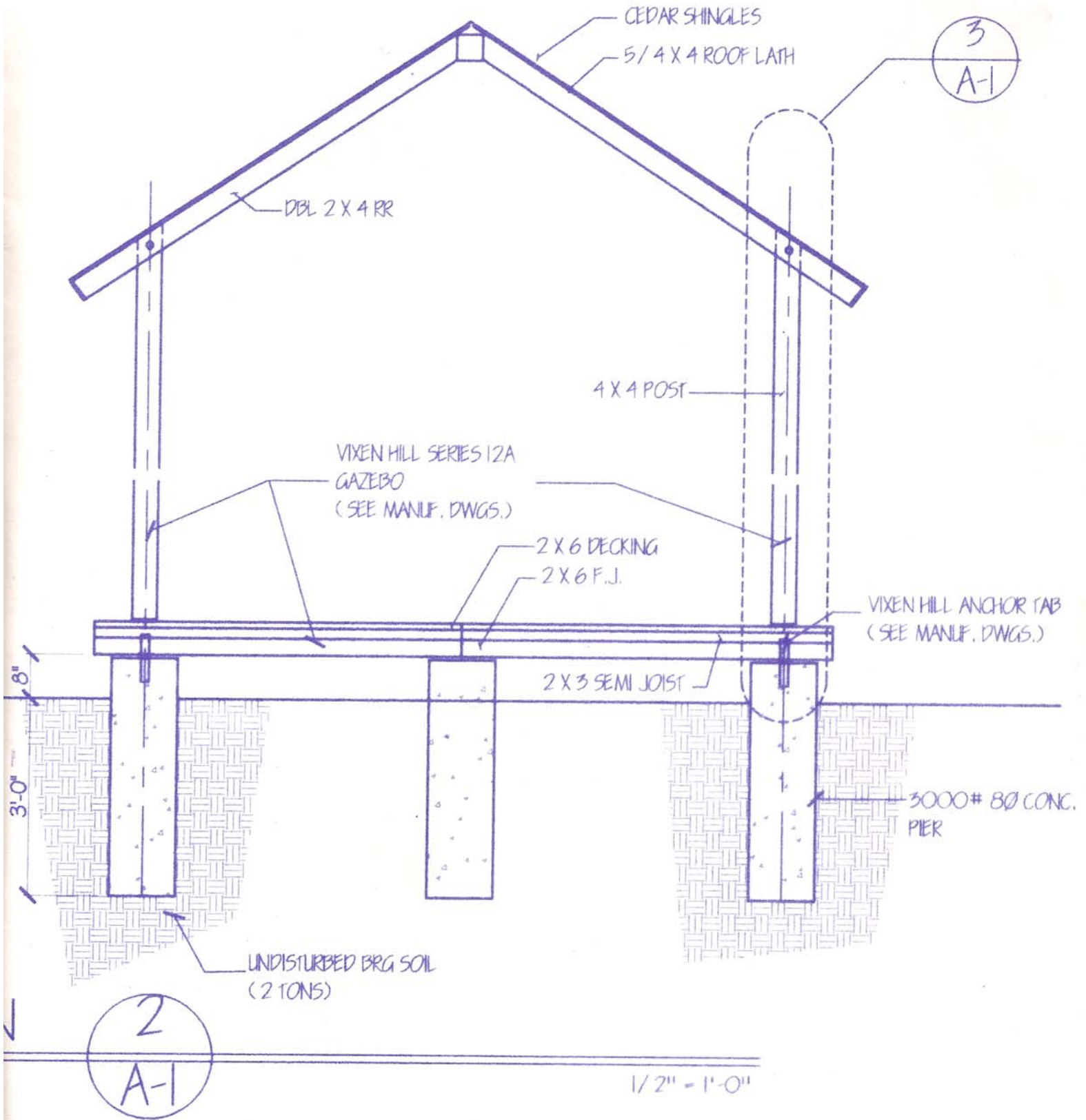

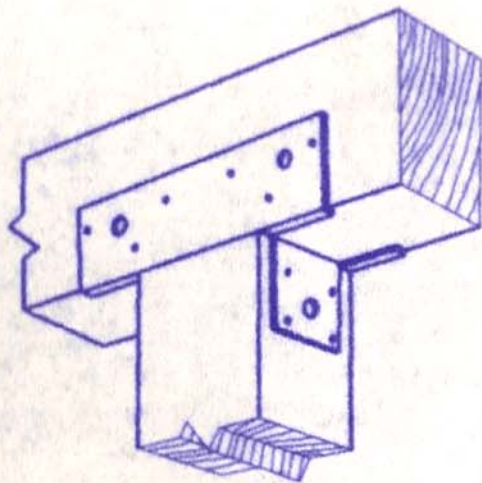

Simpson Strong-Tie
PC

TYPICAL POST TO
BUILT-UP GIRDER

SIMPSON STRONG-TIE PC CONNECTOR
 USE (4) 1/2" HD NAILS
 USE (4) PER CONNECTION

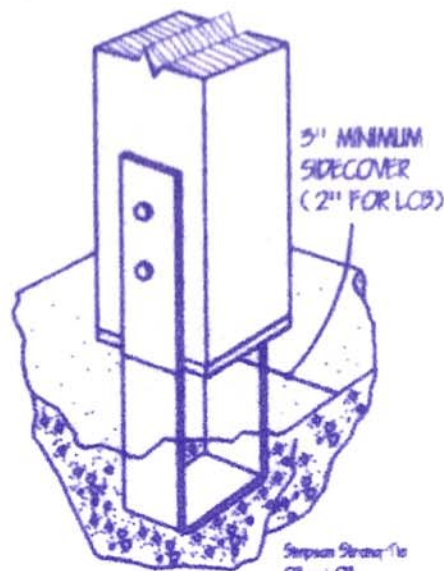

3" MINIMUM
SIDE COVER
(2" FOR LCB)

Simpson Strong-Tie
CB or LCB

TYPICAL POST TO CONC. PIER
CONNECTIONS

SIMPSON STRONG-TIE CB CONNECTOR
 2) 3/8" THROUGH BOLTS

EXISTING DRIVEWAY 545 SF
 PROPOSED DECK 460 SF
 PROPOSED GAZEBO 120 SF
 PROPOSED PAVING 820 SF
 5195 SF

COV. COVERAGE 49%

1	GAZEBO DETAILS	7-22-04
REV.	DESCRIPTION	DATE



FRANK C. GESUALDO
 ARCHITECTS - PLANNERS

77 FLOWER HILL RD
 HUNTINGTON, NY 11743
 (631) 423-1100 FAX (631) 423-0889

THESE PLANS ARE AN INSTRUMENT OF SERVICE AND ARE THE PROPERTY OF THE ARCHITECT. INFRINGEMENTS WILL BE PROSECUTED

CONTRACTOR SHALL VERIFY ALL FIELD CONDITIONS AND DIMENSIONS AND BE RESPONSIBLE FOR FIELD FIT AND QUALITY OF WORK. NO ALLOWANCES SHALL BE MADE IN BEHALF OF THE CONTRACTOR FOR ANY ERROR OR NEGLIGENCE ON HIS PART



PROJECT

McGARRY - DAMBRA
RESIDENCE
 22 KNELL DRIVE
 MASSAPEQUA PARK, NY

DRAWING

FLOOR PLAN

BY **FCG**

SCALE **1/4" = 1'-0"**

DATE **5-24-04**

DWG. NO.

A-1

PROJ. NO **04820**

| OF |